**READ ME !** 

Thank you for purchasing a Front Runner Tubular Rack Clamp Kit.

Before you start, take a moment to familiarize yourself with the Fitting Instructions and the components received.

Refer to Page 2 for a list of all the components, quantities and tools required.

IMPORTANT WARNING! 

IT IS CRITICAL THAT ALL FRONT RUNNER PRODUCTS BE PROPERLY AND SECURELY ASSEMBLED AND ATTACHED TO YOUR VEHICLE. IMPROPER ATTACHMENT COULD RESULT IN AN AUTOMOBILE ACCIDENT, AND COULD CAUSE SERIOUS BODILY INJURY OR DEATH. YOU ARE RESPONSIBLE FOR ASSEMBLING AND SECURING ALL FRONT RUNNER PRODUCTS TO YOUR VEHICLE, CHECKING THE ATTACHMENTS PRIOR TO USE, AND PERIODICALLY INSPECTING THE PRODUCTS FOR ADJUSTMENT, WEAR AND DAMAGE. THEREFORE, YOU MUST READ AND UNDERSTAND ALL OF THE INSTRUCTIONS AND PRECAUTIONS SUPPLIED WITH YOUR FRONT RUNNER PRODUCT PRIOR TO INSTALLATION OR USE. IF YOU DO NOT UNDERSTAND ALL OF THE INSTRUCTIONS AND CAUTIONS, OR IF YOU HAVE NO MECHANICAL EXPERIENCE AND ARE NOT THOROUGHLY FAMILIAR WITH THE INSTALLATION PROCEDURES, YOU SHOULD HAVE THE PRODUCT INSTALLED BY A PROFESSIONAL INSTALLER OR OTHER QUALIFIED PERSONNEL.

NOTE: Front Runner will not be responsible for any damage caused by the failure to install the product according to these instructions.

Please call us if you have any questions about the installation of this product.

1

GET ORGANIZED

IN THE BOX

1	4 X	M8x30 Carriage Bolt
2	4 X	Tubular Rack Clamp
3	4 X	M8 Flat Washer
4	4 X	M8 Nyloc Nut
5	4 X	M8 Nut Cap

TOOLS NEEDED



⚠ Note: Components to be used with most tubular racks, but not included:

RRAC950 - Pelican Case Bracket Small

RRAC951 - Pelican Case Bracket Medium

RRAC952 - Pelican Case Bracket Large

FIGURE 1.1

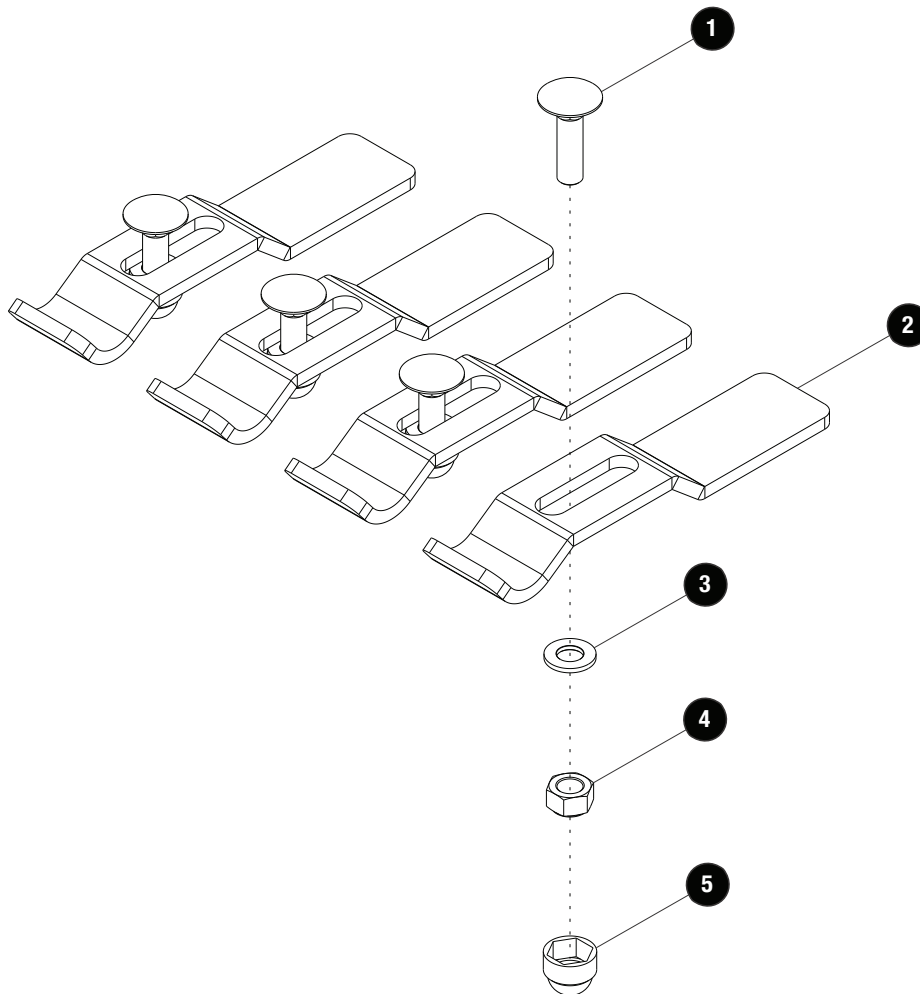

2

FIT AND SECURE

2.1

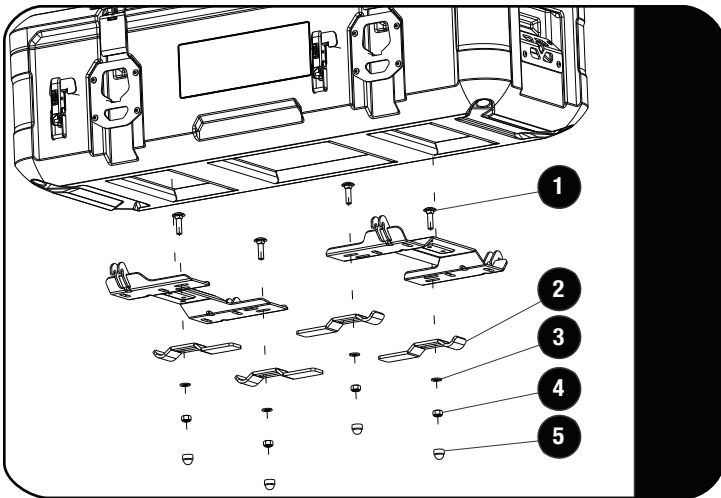

Loosely fit two Tubular Rack Clamps (Item 2) underneath each Pelican Case Base Plate using four M8 x 30 Carriage Bolts, four M8 Flat Washers and four M8 Nyloc Nuts (Item 1, 3, 4).

Fit the Base Plates to your Pelican Case using four RRAC954 Pelican Case Latches (not included).

2.2

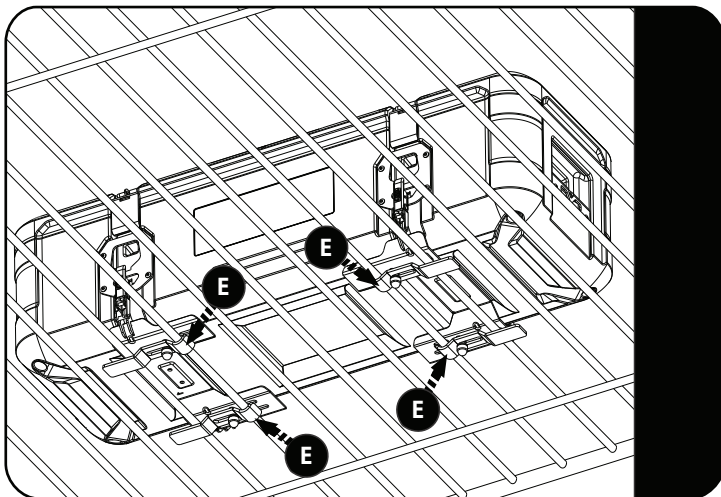

Place the Pelican Case with the attached Base Brackets on the rack having at least two tubular slats under each Base Bracket. Swing the loosely fitted Tubular Rack Clamps to pass between the tubular slats. Adjust the position until the slots with the M8 x 30 Carriage Bolts are equally spaced from their respective tubular slats.



Adjust the Tubular Rack Clamps until the tubular slats are cupped in each Tubular Rack Clamp.

Fully tighten the Tubular Rack Clamps. Finish off by placing two M8 Nut Caps (Item 5) on the M8 Nyloc Nuts.



Do not overtighten to avoid damaging the Base Plate.

3

FINISH

Congratulations! You did it. Take a step back and admire your work!

4

INSTALL OTHER VEHICLE AND RACK ACCESSORIES

Now's the time to visit your favorite Front Runner Dealer in person or online.

Be sure to tag us. We love to see our gear in action! #FrontRunnerOutfitters #BornToRoam

Share your adventures on:

